

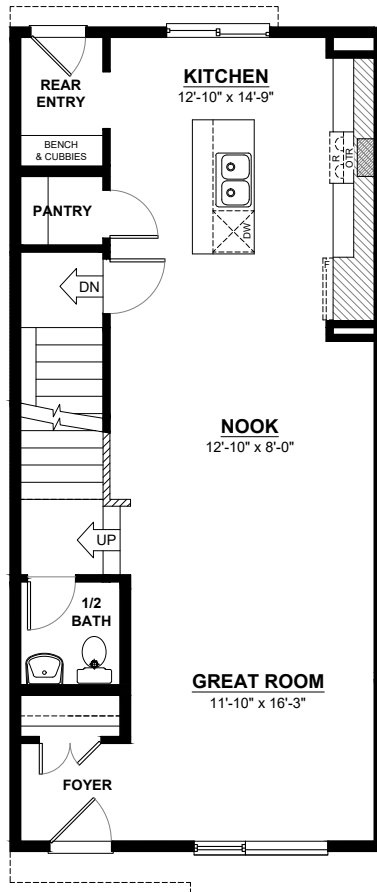

# THE VICTORIA M

2 STOREY • 1,485sq.ft.



**MAIN FLOOR**  
720sq.ft.  
(9 FT. CEILINGS)

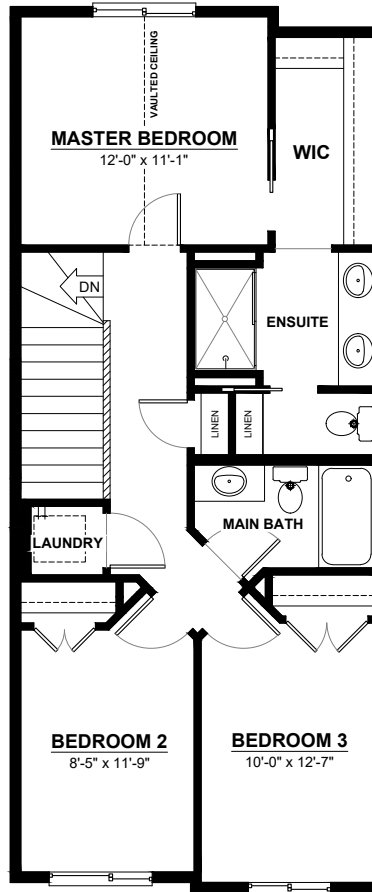

**2ND FLOOR**  
765sq.ft.  
(8 FT. CEILINGS)

## FEATURES

- 3 bedrooms
- 2 1/2 bathrooms
- Vaulted Master Bedroom
- Large Walk In Closet
- Designer Ensuite with Dual sinks
- Second Floor laundry
- Quartz Counter Tops in Kitchen
- Large Walk in Pantry
- Mudroom with Built-In Bench/Cubbies

This plan is the property of City Homes. All rights reserved, including the right of reproduction in whole or in part. Image shown is an artist rendering, dimensions shown are approximate and are subject to change. Square footage may vary based on elevation. Please consult your City Homes Sales Consultant. Blacklines revised January 7, 2020.

