

THE BROOKLYN

2 STOREY • 1,652sq.ft.

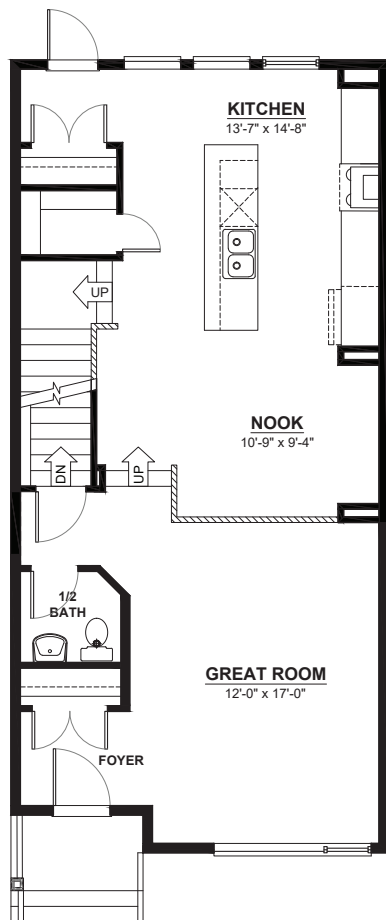

MAIN FLOOR

826sq.ft.
(9 FT. CEILINGS)

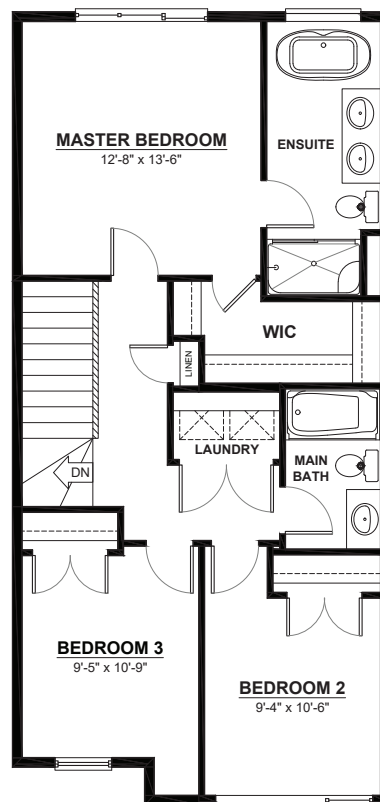

2ND FLOOR

826sq.ft.
(8 FT. CEILINGS)

FEATURES

- 3 bedrooms
- 2 1/2 bathrooms
- 5 piece ensuite
- 2nd floor laundry
- Master walk-in closet
- Walk-in pantry

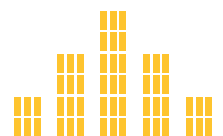

CITY HOMES
MASTER BUILDER

This plan is the property of City Homes. All rights reserved, including the right of reproduction in whole or in part. Image shown is an artist rendering, dimensions shown are approximate and are subject to change. Square footage may vary based on elevation. Please consult your City Homes Sales Consultant. Blacklines revised December 11, 2020.